

HILTON FRANKFURT CITY CENTRE



Situated in the heart of the city, next to an idyllic park, Hilton Frankfurt City Centre offers urban and loft living style guest rooms and freshly renovated world-class meeting facilities.

Enjoy all-day-dining at the Hudson Yards Bar, Lounge & Dining and a state-of-the-art Health and Fitness Club, or explore the city's most popular shopping destinations and major tourist attractions within walking distance of the hotel.

AT A GLANCE

- close to major business, shopping and tourist destinations
- 342 urban guest rooms including 14 suites and the Presidential suite
- 3 Executive Floors with Executive Lounge access
- Ballroom with capacity for up to 550 people
- 16 modern event and meeting rooms
- PARK Restaurant & Terrace and Hudson Yards Bar, Lounge & Dining
- 2,000m² Health & Fitness Club with a 25m swimming pool



GUEST ROOMS

Urban, bright and airy, all 342 guest rooms and suites offer the ideal environment for work, rest and relaxation. Facilities include a separate shower and bathtub, air conditioning, sound-insulated windows, flat-screen TV, working desk and high speed wireless internet access.

Guests staying on our Executive Floors benefit from special services, including complimentary snacks and drinks in the exclusive Executive Lounge.



HEALTH & FITNESS

Keep up with your exercise routine at the Health & Fitness Club where state-of-the-art facilities include a gym, sauna, steam bath and whirlpool. The 25m indoor pool is the largest hotel pool in Germany and offers stunning views of the park.



EAT & DRINK

PARK RESTAURANT & TERRACE

Enjoy a relaxing breakfast at the PARK Restaurant & Terrace – the perfect place to start your day, with a stunning view of the idyllic park. In the summer time, or when weather allows, seating is also available on the terrace.

HUDSON YARDS BAR, LOUNGE & DINING

It is time for a slice of New York with a Frankfurt twist. Be tempted by culinary delights. Savour original takes on classic cocktails. Relax and enjoy our genuine, passionate hospitality in contemporary, cosmopolitan surroundings. Relish the international and revel in the local. Our menu features local and New York classics alongside our chef's new creations

SUMMER TERRACE

Come along and enjoy our spacious terrace with a great view of the park. Open in the summer months or also available for events throughout the year.



OUT & ABOUT

Frankfurt is not only the financial capital of Germany, but also a vibrant cultural centre, offering many attractions and exciting events. From classical music productions to culinary festivals, Christmas markets to river cruises, the city offers something for everyone.



LOCATION

Conveniently located just five minutes from the business and banking district, Hilton Frankfurt City Centre provides an excellent base for business or leisure. Enjoy easy access to the city centre and many historical and shopping destinations from this downtown hotel. Frankfurt Airport, Frankfurt Central Station and the fairground are easily accessible within only a few minutes via car or public transport.

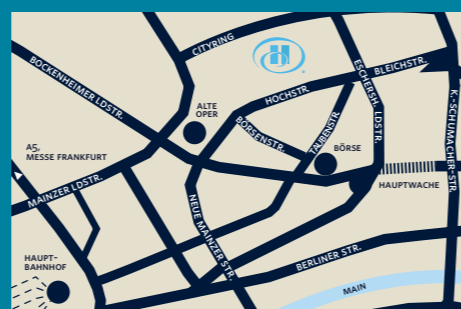

HERE ON BUSINESS

State-of-the-art meeting spaces and premium facilities make Hilton Frankfurt City Centre an ideal venue for all kinds of events. Our 16 bright and modern event and meeting rooms can accommodate up to 550 people and most of them offer natural daylight. For outdoor events, Hilton Frankfurt City Centre offers a beautiful Terrace or the Nebbiensche Gartenhaus in the adjoining park. Our dedicated Conference & Event team will ensure that your event is a full success.

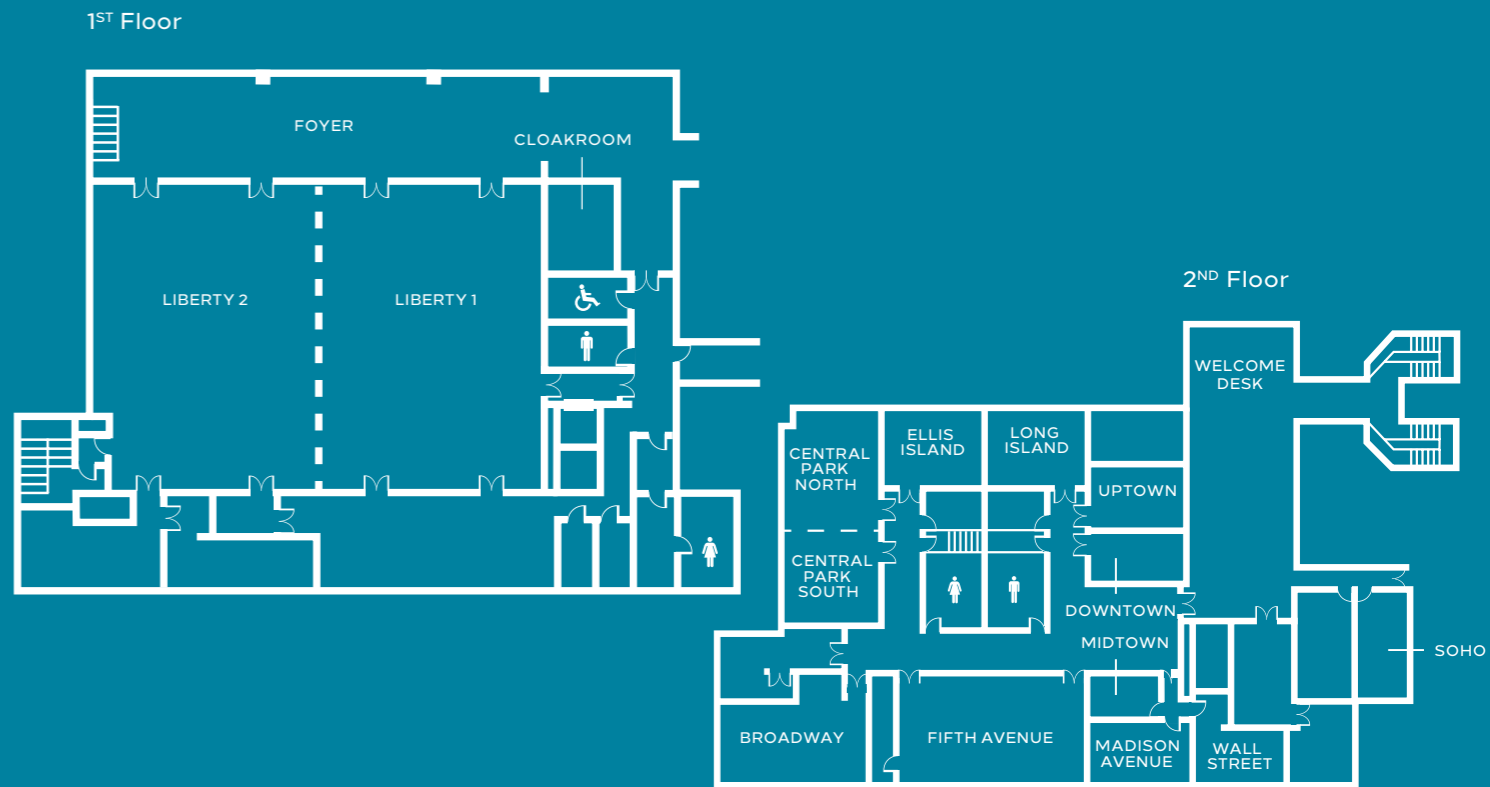

	Reception	Theatre	Classroom	Boardroom	U-Shape	Banquet	Cabaret	Floor	Dimensions W x L x H (m)	Area (sqm)	Natural Daylight	Air-conditioning	Power Current	Accessible by Vehicle
Central Park North	40	30	28	15	18	30	18	2	8,6 x 6,2 x 2,8	53	•	•	-	-
Central Park South	40	30	28	15	18	30	18	2	7,6 x 6,2 x 2,8	47	•	•	-	-
Central Park North + South	80	80	54	39	42	80	42	2	16,2 x 6,2 x 2,8	100	•	•	-	-
Fifth Avenue	60	58	45	27	30	50	42	2	13,6 x 6,5 x 2,8	88	•	•	-	-
Broadway	50	48	27	21	24	30	18	2	10,4 x 6,0 x 2,8	62	•	•	-	-
Madison Avenue	-	-	-	15	-	-	-	2	6,5 x 4,0 x 2,8	26	•	•	-	-
Wall Street	-	-	-	12	-	-	-	2	6,8 x 3,9 x 2,8	27	•	•	-	-
Ellis Island	20	25	-	15	-	-	-	2	7,1 x 4,5 x 2,8	32	•	•	-	-
Long Island	20	25	-	15	-	-	-	2	7,1 x 4,5 x 2,8	32	•	•	-	-
Uptown	25	30	-	15	-	-	-	2	6,2 x 4,6 x 2,4	28	-	•	-	-
Downtown	-	25	-	15	-	-	-	2	3,7 x 6,2 x 2,4	26	-	•	-	-
Soho	15	20	-	15	-	-	-	2	3,7 x 6,2 x 2,4	26	•	•	-	-
Liberty 1	350	198	144	39	48	120	84	1	13,8 x 17,8 x 4,0	245	-	•	•	-
Liberty 2	350	198	144	39	48	120	84	1	13,2 x 17,8 x 4,0	235	•	•	•	-
Liberty 1+2	550	550	250	120	120	290	200	1	27,0 x 17,8 x 4,0	480	•	•	•	-
Liberty Foyer	250	-	-	-	-	-	-	1	27,0 x 6,9 x 4,0	202	•	•	•	-
Westside	-	-	-	9	-	-	-	2	4,0 x 3,2 x 2,5	13	-	•	-	-
Midtown	-	-	-	6	-	-	-	2	4,3 x 3,2 x 2,8	14	-	•	-	-



Hilton
FRANKFURT CITY CENTRE



“IT HAS BEEN, AND CONTINUES TO BE,
OUR RESPONSIBILITY TO FILL THE EARTH WITH
THE LIGHT AND WARMTH OF HOSPITALITY.”

Conrad N. Hilton

Hilton Frankfurt City Centre

Hochstraße 4 | 60313 Frankfurt am Main | Germany

 HiltonFrankfurt

 frankfurt_city_centre

E: info.frankfurt@hilton.com

frankfurt.hilton.com